



TECHNICAL BULLETIN – TB010

Affected Part Numbers

Gen II Connection Kit - Part Number OC15SUK12B

A new guide tube assembly for Mercruiser and Volvo Sterndrives was introduced in July 2012. The new guide tube was introduced to simplify the assembly and installation of the connector kit for these Sterndrives. It replaces the previous guide tube assembly, and will be supplied from the factory on all future shipments of this connector kit.

The NEW guide tube assembly will replace the OLD guide tube assembly as shown below:

**NEW Guide
Tube Assembly**

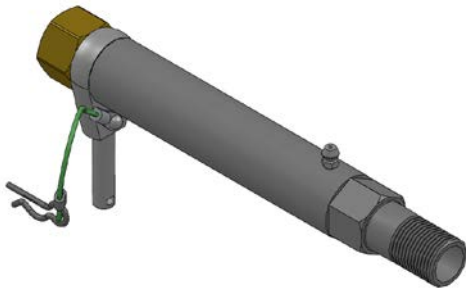

**OLD Guide
Tube Assembly**

