



TECHNICAL BULLETIN – TB005

Affected Part Numbers

OC17SU01 - Bypass Valve Assy 12v

OC17SU02 - Bypass Valve Assy 24v

OC17SU04 - Shut Off Valve SAE Ports

Some Gen II Reversing Pumps – Built after Nov 2007

Modified Pump Modules were introduced into Octopus Reversing Pumps in the fall of 2007. The 'O' ring Seal Pattern between the front face of the pump housing casting and the accessory is NOT interchangeable with the accessories listed above. The affected accessories have been modified to a Gen II level and are backwards and forwards compatible.

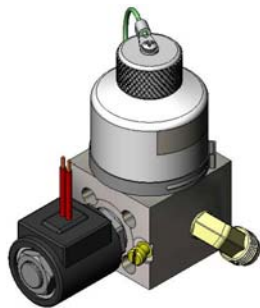

Gen I Bypass Valve



Gen I SAE Shut Off Valve – 2” Dia



Gen I Pump Module

Gen I Accessories – Compatible with Gen I Pump Module Only

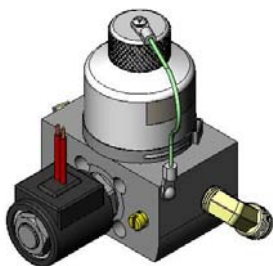

Gen II Bypass Valve



Gen II SAE Shut Off Valve – 2-1/2” Dia



Gen I Pump Module

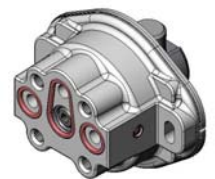

Gen II Pump Module

Gen II Accessories – Compatible with Gen I & II Pump Modules

When fitting accessories or replacing a pump module ensure that the mating 'O' Ring Seal Pattern is compatible. 3 x # 013 'O' Rings for Gen I – 2 x # 012 & 1 x # 017 'O' Rings for Gen II.